

Issue: May 2021



2021

**PRODUCT
CATALOGUE**

Chubb

Table of Contents

About Chubb	iv
Chubb Exclusive Agencies	v
Nozzles	1 - 3
Nozzles NSW/AFAC contract	1
Protek Nozzles	2
Foam Aeration Tubes	2
Protek Servicing	2
Quell Fog Nozzles	3
Plexone Fog Nozzles	3
Waterway Equipment	4
Wyes (dividing breech)	4
Fire Monitors	5
Chubb Striker Monitors.....	5
Protek Monitors	6
Angus Fire Monitors	7
Fire Hose	8 - 10
Extruded Duraline	8
Extruded Firechief	8
Aquafire	9
Super Cobra	9
Fire Hose Accessories	10
Testing, Repair and Maintenance	11
Fire Depot Bins	11
Fittings and Couplings	12 - 16
Storz Fittings and Couplings	12
Threaded Couplings and Adaptors	13
Storz Reducers	13
Storz Blanking Caps	13
Storz Washers – Suction & Delivery.....	14
Storz Suction Strainers	14
Storz Spanners	14
Forestry Couplings	15
Forestry Expanders	15
British Instantaneous	16

Firefighting Foams	17 - 24
About firefighting foams	17
Forexpan	18
Expandol	18
Class B C6 Foam	19
- Tridol C6 S	19
- Tridol C6 ATF C	19
Respondol Fluorine Free	20
Foam Testing Services	20
Protein Foam:	
- Niagara C6 3-3	21
- Tankmaster C6	21
BlazeTamer™ 380	22
Foam Equipment	24
Forestry Equipment.....	25
Firebug Fire Control Torch	25
Firebug Spare Part Kits	25
Rega Rake Hoe and Knapsack	25
Forcible Entry Tools.....	25
MFC Survival	26 - 28
High Pressure Airbags	26
Controllers and Regulators	26
Low Pressure Airbags	26
Rapid Response Shelters	27
Decontamination Showers	27
Water Rescue Equipment	27
Water Storage	28
Hazmat Equipment	28
Respirex	29 - 31
PRPS Suits	29
Limited Life Suits	30
Splash Suits - Liquid Tight	30
Disposable Suits	30
Splash Suits	30
Air Fed Suits	31
Kool Vest	31
Body Bags	31
Gloves and Boots	31
Thermal Imaging Cameras.....	32



Chubb

Chubb takes your business safety as seriously as you do and is committed to providing you with the highest quality fire safety solutions.

As each business has unique fire safety requirements, we will take the time to understand the fire hazards in your business and recommend a solution to minimise your risk.

Chubb can provide:

- A comprehensive range of fire and safety products and services
- Experienced and professional staff
- A national network of local branch offices
- Installation and service support Australia wide
- Fire safety risk assessment
- Regular testing and maintenance of fire equipment
- Fire and safety training

Chubb Fire & Security Pty Ltd is part of Carrier, a leading global provider of innovative HVAC, refrigeration, fire, security and building automation technologies.

Visit us at

www.chubbfiresecurity.com

Chubb Exclusive Agencies

Chubb are proud to be the exclusive Australian distributors for some of the world's leading fire and rescue brands.



Angus Fire

Angus Fire is a global leader in firefighting technology with a remarkable history in manufacturing fire protection products that can be traced back over 220 years. Angus Fire has continued to innovate using the latest technology to develop high quality, high performance products.

Angus Fire maintains its position at the forefront of fire protection technology through continuous investment in research and development. Its unique combination of technical expertise in rubber and textile technology (fire hose), speciality chemicals (foam concentrates) and engineering design (firefighting equipment) has enabled it to achieve numerous technological 'firsts'.



BLAZETAMER380

Chubb are proud to represent the BLAZETAMER380 aerial water enhancer from BioCentral Laboratories within the Australian market. Water enhancers like the polymeric elastomer BLAZETAMER380™ represent the future for firefighting. BLAZETAMER380™ is an effective and valuable fire suppressant for direct attack of fires during initial or extended attack operations. It can be used in engines, slingable bags, drop tanks, and can be ground-loaded, mixed in dip tanks for helicopters with buckets or used with on-board injection systems in helicopters, SEATs, water-scooping and land-based, multi-engine air-tankers.



Protek Manufacturing Corporation

Partners since 1993, Protek have become a leading brand among fire services. Their comprehensive range of nozzles, monitors and waterway products have been proven time and again to provide the performance and reliability demanded by fire services and industry.



Respirex International

Respirex are a world leading supplier of personal protective solutions, specialising in the design and manufacture of high-performance chemical, particulate and respiratory protective clothing and specialist protective footwear.

The Respirex product range encompasses gas tight suits, chemical splash suits and CBRN equipment for fire and emergency services teams and emergency responders; air fed chemically protective suits and chemical work wear for the petrochemical and pharmaceutical industries and powered air and air fed particulate suits and hoods for nuclear and pharmaceutical industries. Their state of the art automated footwear factory produces a range of protective boots and overboots providing protection from hazardous chemicals and high voltages, along with specialist food industry boots and general safety boots.

Nozzles - NSW/AFAC Contract



Range of Prottek nozzles available for NSW/AFAC contract.

Ordering information	Description	Key features
150-360ST25NSW	Prottek 360 nozzle	25mm Selectable flow nozzle 25mm Storz swivel inlet Flows 19-37-90-150 LPM Pistol grip and ball shut off
150-361ST25NSW	Prottek 361 nozzle	25mm Selectable flow rate nozzle 25mm Storz swivel inlet Flows 50-100-150-230 LPM Pistol grip and ball shut off
150-361APBNH	Prottek 361 nozzle	25mm Selectable flow rate nozzle 25mm NH inlet Flows 50-100-150-230 LPM Blue pistol grip and handle
150-362NHBL	Prottek 362 nozzle	25mm Selectable flow rate nozzle Flows 50-90-115 LPM Blue pistol grip and handle
0500058 C2.2	Prottek 366 nozzle	38mm Selectable flow rate nozzle 38mm Storz swivel inlet Flows 115-230-360-475 Pistol grip and ball shut off

Rotary Head Nozzles

Standard features include:

- 25mm Storz coupling
- Adjustable head
- Variable flow settings



Range of Rotary Head nozzles available for NSW/AFAC contract.

Ordering information	Description	Key features
ROTCASTST	Rotary Head nozzle	Cast iron body
MULTIJET25ST	Rotary Head nozzle	Alloy body

Basic Spray Nozzles

Standard features include:

- 25mm Storz inlet
- Shut off jet, spray or fog



Basic Spray nozzles available for NSW/AFAC contract.

Ordering information	Description
SL100 and ST2525MAD	Basic Spray nozzle



Looking for other sizes?
 Contact your Chubb representative to discuss your requirements.

Protek Nozzles



Ordering information	Description
Industrial Fog Nozzle	
150-8104	Industrial Fog 1 1/2" Fog Nozzle, Brass
Protek Selectable Gallonage Nozzles	
150-360AP	25mm BSP Female 19-37-90-150 LPM
150-361AP	25mm BSP Female 7 Bar 50-100-150-230 LPM
150-361F	25mm BSP Female 5 Bar 50-100-150-230 LPM - low pressure nozzle
150-366AP	38mm BSP Female 7 Bar 115-230-360-475 LPM
150-366F	38mm BSP Female 5 Bar 115-230-360-475-570 LPM - low pressure nozzle
150-366EH	38mm BSP Female 7 Bar 115-230-360-475 LPM with integrated extendable foam tube
150-368AP	65mm BSP Female 360-475-550-750-950 LPM

Foam Aeration Tubes



Ordering information	Description	Key features
150-212AG	Foam aeration tube (NSW Contract)	38mm Foam aeration tube Suits Protek style 150-366
150-214	Foam aeration tube	65mm Foam aeration tube Suits Protek styles 367/368/369

Protek Servicing

Ordering information	Description
150-O/HAUL	Labour repair Protek nozzle (parts not included)
150-1000	Protek repair kit for 360-361
150-1001	Protek repair kit for 366
150-1002	Protek repair kit for 367

As an industry leader in fire equipment, Protek delivers unparalleled quality. With customers in over 40 countries, Protek's ISO 9001 certification proves its relentless dedication to quality.



Quell Fog Nozzles



Ordering information	Description
101369	Quell TA25 - 38mm, Alloy
100204	Quell TB25 - 38mm, Brass
100200	Quell TPB15 - 25mm
108300	Quell TPB15 - 32mm
100203	Quell TPB15 - 38mm
100198	Quell TB15 - 25mm, Brass
103818	Quell TB15 - 38mm, Brass
100193	Quell TPB10 - 19mm
100197	Quell TPB10 - 25mm
100191	Quell TB10 - 19mm, Brass
100194	Quell TB10 - 25mm, Brass

Plexone Fog Nozzles



Ordering information	Description
SL075	Fog Nozzle 19mm BSP F c/w Bumper
SL100	Fog Nozzle 25mm BSP F c/w Bumper
SL150	Fog Nozzle 38mm BSP F c/w Bumper

Wyes (dividing breech)



- Wyes (dividing breech) enables two two hoses to run off one water supply
- Siamese (collecting breech) enables two water supplies to feed into one

Standard features include:

- Divide one water supply into two
- Enables two hoses to operate off one water supply
- Made from aluminium
- Swivel inlets and outlets
- Ball valve operated



Ordering information	Description	Key features
Wyes		
ST65DIV	65mm Controlled Wye	German Made 1 x 65mm BSP female inlet 2 x 65mm BSP male outlets Aluminium alloy
ST65DIVST65	65mm Controlled Wye with storz fittings	German Made 1 x 65mm BSP female inlet 2 x 65mm BSP male outlets Fitted with storz adaptors Aluminium alloy
150-505	Protek 25mm Controlled Wye	1 x 25mm BSP female inlet 2 x 25mm BSP male outlets Aluminium alloy
150-506	Protek 38mm Controlled Wye	1 x 38mm BSP female inlet 2 x 38mm BSP male outlets Aluminium alloy
150-506ST38NSW	Protek 38mm Controlled Wye	1 x 38mm storz inlet 2 x 38mm storz outlets Aluminium alloy
Siamese		
ST100COLBRE	100mm Controlled Siamese	UK Made 2 x 65mm BSP male inlets 1 x 100mm Storz outlets Aluminium alloy
150-545	Protek 65mm Controlled Suction Siamese	Used as suction inlet collection for pumpers Self-locking handle for positive handle positioning 2 x 65mm f swivel inlet with strainers 1 x 65mm female outlet (up to 150mm available) Aluminium alloy Brass available (150-545BC)
150-555	Protek 65mm Controlled 3-Way Suction Siamese	Used as suction inlet collection for pumpers Self-locking handle for positive handle positioning 3 x 65mm f swivel inlets with strainers 1 x 65mm female outlet (up to 150mm available) Aluminium alloy
150-585	Protek 65mm Clappered Valve Siamese	Clappers allow additional lines to be added without interrupting flow 2 x 65mm female inlet with strainers 1 x 65mm female outlet (up to 150mm available) Aluminium alloy

Chubb Striker Monitors

Chubb offer the Striker range of manual fixed monitors manufactured in Australia for Australian conditions.

Standard features include:

- Sizes 38mm (1 ½”), 50mm (2”), 65mm (2 ½”) 76mm (3”) and 100mm (4”)
- Available with male threaded BSP inlets or 3 and 4” ANSI Flanged Inlets.
- Male BSP outlets on all monitors to suit a variety of fixed tips or fog/jet nozzles.
- High corrosion resistance - rugged 316 SS construction and fasteners with nitrile synthetic rubber seals. Perfect for all weather installations
- Full flow waterway.
- 360° rotation with elevation from 75° above to 45° below horizontal.
- The rotating joints can be locked into place and therefore be set and left to work unattended.
- Short handle option for vehicle mounts available.
- Narrow front to back profile - ideal where space is limited
- Suitable for firefighting, wash down and dust suppression applications.
- Double row ball bearings on all movements







Ordering information	Description
STKR38VM	Male 38mm BSP inlet, Male 38mm BSP outlet – Long handle.
STKR38VMB	Male 38mm BSP inlet, Male 38mm BSP outlet – Short handle.
STKR38FLG3	3” ANSI Flange inlet, Male 38mm BSP outlet – Long handle.
STKR50	Male 2” BSP inlet male, vehicle mount – Long handle
STKR50/F1	Male 2” BSP inlet male, vehicle mount – Bent / Tiller handle
STKR50VM	Male 2” BSP inlet, Male 2” BSP outlet – Long handle.
STKR50FLG3	3”ANSI Flange inlet, Male 2” BSP outlet – Long handle.



Protek Monitors

Protek's wide selection of high-quality monitors optimise advanced computer aided design and testing technology, offering features such as cast-in vanes for high flow efficiency with minimised flow turbulence. Protek monitors are highly manoeuvrable and easy to operate, offering optimal coverage in industrial, mining and marine environments.

All monitors are compatible with Protek's diverse range of master stream nozzles.

Ordering Information	Description	Key Features
150-600 	Portable ground monitor	<ul style="list-style-type: none"> Available in single or dual inlet 64mm BSP inlet / outlet Simple to set up for quick attack operations Flow rate of up to 1900 LPM (500 GPM) Horizontal rotation is adjustable 20° each side of centre Elevation is adjustable from 30° to 60° unmanned, down to 20° when manned Hard-coat anodized aluminium alloy construction Ball shut-off with locking handle Carbide-tipped spikes at the base is resistant to long-term wear and provide excellent ground stability
150-622 	Dual Purpose Portable Ground Monitor	<ul style="list-style-type: none"> Available in single or dual inlet or deck mount 64mm BSP inlet / outlet Full 3" waterway for flow rate of up to 3800 LPM (1000 GPM) Vertical travel of 63° from 12° to 75° with inbuilt 37° safety stop from 18° to 55° Carbide-tipped spikes Fully enclosed worm gear is protected from the elements Liquid-filled pressure gauge Dual spring-loaded lock pins for quick and easy break-apart Spring-loaded forged aluminium folding legs
150-636 	Industrial Monitor	<ul style="list-style-type: none"> Full 2-1/2" waterway for flow rate of up to 2900 LPM (750 GPM) Corrosion resistant brass construction Ideal for marine, offshore, industrial and other corrosive environment Vertical travel up to 135° and 360° rotation Cast-in turning vanes for efficient flow and minimal friction loss Positive friction locks for both horizontal and vertical travel to hold desired position Compact design and low-profile FM approved
150-649 	Industrial Monitor	<ul style="list-style-type: none"> Full 3" waterway for flow rate of up to 4800 LPM (1250 GPM) Choice of 3" or 4" flange or 3" female thread inlet Ideal for marine, offshore, industrial and other corrosive environment Vertical travel up to 150° and 360° rotation Corrosion resistant brass construction Cast-in turning vanes for efficient flow and minimal friction loss Highly manoeuvrable and easy to operate Positive friction locks for both horizontal and vertical travel to hold desired position Compact design and low-profile FM approved
150-918 	Oscillating Industrial Monitor	<ul style="list-style-type: none"> Combination of Style 911 Oscillating Flange and Style 611 Industrial Monitor Rugged and flow-efficient monitor with high reliability and minimal maintenance Full 3" waterway for flow rate of up to 4800 LPM (1250 GPM) 30° to 330° adjustable rotation 3" Flange, 4" Flange or 6" Flange inlet. 2 1/2" Outlet
150-911 	Oscillating Flange	<ul style="list-style-type: none"> Readily transforms a manual monitor into an oscillating monitor Very easy to set up by unbolting the existing monitor and inserting either the oscillating flange conversion kit between the flanges All oscillating flange components are constructed of high-grade brass for superior resistance to corrosion and wear Oscillating movement is generated through a pelton wheel driven by water power Totally water-powered (no electric connections) Heavy-duty low friction loss brass waterway Designed for refineries, process plants, tank farms, tank loading areas, offshore installation and other high-risk areas

Angus Fire Monitors

Ordering Information	Description	Key Features
HM80	Hand Operated Monitor	<p>Maximum flow 4,500 litres/min Inlet flange connection - 4" ANSI Class 150 RF (alternatives to special order) Outlet connections - 2", 2½" BSP Male or flanged for LTC Cannons (alternatives to special order) Rotation - 360° continuous Elevation (nominal) - +75°-75° from horizontal Manufactured from only high grade corrosion resistant materials including gunmetal, bronze and 316 stainless steel. Can be adapted to a geared, oscillating, or remote control monitor specification over time Main body of the HM-80 can be orientated in either an upright configuration, or compact low profile model making this monitor particularly suitable for installation on towers, offshore platforms and other areas where space is limited.</p>
OM80	Oscillating Monitor	<p>Maximum flow 4,500 litres/min Inlet flange connection - 4" ANSI Class 150 RF (alternatives to special order) Outlet connections - 2", 2½" BSP Male or flanged for LTC Cannons (alternatives to special order) Compact low profile configuration, makes this monitor particularly suitable for installation on towers, aircraft hangars, offshore platforms for helideck protection and other areas where space is limited. The OM80 is engineered to withstand severe environmental conditions and provide exceptional operational reliability, long life and extremely low maintenance. A sealed for life gearbox is provided with adjustable sweep angle between 45° and 120° in 15° intervals and an oscillating speed control. Sealed low friction joints ensure easy movement even at high operating pressures</p>
MM1	Hand Operated Monitor	<p>The MM1 is a lightweight and cost-effective manual monitor, designed for use at operating pressures between 5 and 15 bar g.</p> <ul style="list-style-type: none"> • Maximum flow 4,500 litres/min • Inlet flange connection 4" ANSI Class 150 FF (alternatives to special order) • Outlet 2½" BSP Male (alternatives to order) • Corrosion resistant gunmetal construction • The single 75mm (3") waterway • Built-in flow straighteners provide optimum hydraulic efficiency • Full 360° rotation, travel covering 85° above and 50° below horizontal. • Separate friction locks will maintain the monitor position, once set for prolonged unattended operation. • Smooth movement is provided by a double row of bearings at each rotating joint with precise adjustment controlled by a stainless steel positioning handle.



Fire Hose

Extruded Duraline and select assemblies

- Significantly exceeds the most demanding international standards for resistance to kinking, abrasion, heat, chemicals, oil weathering, ultra violet light and ozone
- Designed for the longest possible storage life
- All hose is H Class and carries or conforms to Australian Standard 2792:1992
- Assemblies available with a variety of coupling choices and may be coupled using bandit clamp wire whipped or expansion method
- No drying required

Ordering information	Description
DU25730U	Angus Duraline / Flexline 25mm x 30m Bare, Red
DU25730YU	Angus Duraline / Flexline 25mm x 30m Bare, Yellow
DU38730U	Angus Duraline 750 38mm x 30m Bare, Red
DU38730YU	Angus Duraline 750 38mm x 30m Bare, Yellow
DU45730U *	Angus Duraline 750 45mm x 30m Bare, Red (British std)
DU52730U	Angus Duraline 750 52mm x 30m Bare, Red
DU52730YU	Angus Duraline 750 52mm x 30m Bare, Yellow
DU64730U	Angus Duraline 750 65mm x 30m Bare, Red
DU64730YU	Angus Duraline 750 65mm x 30m Bare, Yellow
DU89530U *	Angus Duraline 89mm x 30m Bare, Red (British std)
DU25FOR25	Angus Duraline / Flexline 25mm x 30m c/w forestry couplings
DU38FOR38	Angus Duraline 750 38mm x 30m c/w Forestry Couplings & Expansion Ring, Red
DU38ST38BC	Angus Duraline 750 38mm x 30m c/w Storz couplings and bandit clamps, Red
DU64ST65BCR	Angus Duraline 750 65mm x 30m c/w 65mm Storz Couplings & Bandit Clamps, Red

* certified to BS6391 Type 3



Extruded Firechief and select assemblies

Ordering information	Description
FF38730U	Angus Firechief 38mm x 30m Bare
FF64730U	Angus Firechief 65mm x 30m Bare
FF38FOR38	Angus Firechief 38mm x 30m c/w Forestry Couplings & Expansion Ring
FF64ST64BC	Angus Firechief 64mm x 30m c/w 65mm Storz Couplings & Bandit Clamping



Looking for other sizes and combinations? No problem.

Contact your Chubb representative to discuss your requirements.

Aquafire

Standard features include:

- All hose is H Class and certified to Australian Standard 2792:1992
- Maintenance free
- Excellent weathering resistance
- Good heat resistance

Ordering information	Description
AQ38730U	Angus Aquafire 38mm x 30m Bare
AQ64730U	Angus Aquafire 64mm x 30m Bare

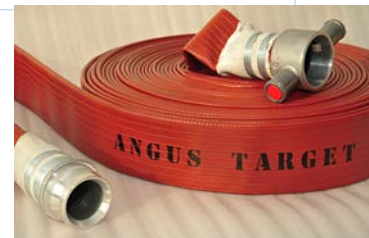

Super Cobra

Designed for use by fire brigades operating under rigorous and demanding conditions and industrial customers.

Light and flexible when wet or dry due to the use of synthetic yarns.

Standard features include:

- Class H
- Non-percolating
- PVA & polyester do not swell on contact with water
- PVA is ideal as a warp yarn for fire hose to give a longer life than all filament hoses
- Smooth seamless rubber lining guarantees very low friction loss

Ordering information	Description
Super Cobra	
SCB25730Z	25mm x 30m Bare
SCB38730Z	38mm x 30m Bare
SCB64730Z	64mm x 30m Bare
SCB2530ST25BCHS	25mm x 30m c/w Storz couplings, hose straps
SCB3830ST38BCHS	38mm x 30m c/w Storz couplings, hose straps
SCB6430ST64BCHS	65mm x 30m c/w Storz couplings, hose straps
SCB25FOR25	25mm x 30m c/w Forestry Couplings & Expansion Ring
SCB38FOR25	38mm x 30m c/w Forestry Couplings & Expansion Ring
38mm and 64mm hose certified to AS2792:1992. Class H, 25mm hose conforms to AS2792:1992. Other couplings available.	



Fire Hose Accessories

Chubb offer a complete range of fire hose accessories to assist in prolonging the life span of fire hose and also to help customise hose to suit particular firefighting needs.

Ordering information	Description
Hose Bandage	
071-038	Hose Bandage 38mm
071-064	Hose Bandage 64mm
Textile Hose Repair Patches	
VP35	Vulcanising Patch 35mm
VP50	Vulcanising Patch 50mm
VP65	Vulcanising Patch 65mm
VSOL	Vulcanising Solution Tub 250ml
Extruded Hose Repair Patches	
STEN3223	Stenor Patches Red 12 Internal / 12 External
STEN32234	Stenor Patches Yellow 12 Internal / 12 External
Stenor Vulcanising Unit	
STENOR	Stenor Merlin Machine Complete

Testing, Repair & Maintenance

Chubb provide comprehensive hose repair and testing services for both extruded and conventional fire hoses. Select services are available for all brands of hose whilst some are restricted to Angus Fire hose only. Services provided for Angus Fire hose are:

- Rewire whipping and coupling of fire hose ends
- Hose patching, test and drying of both conventional and extruded hose
- Recoupling and banding of 38mm, 51mm, 64mm and 90mm hose
- Rebrand and stencil hose
- Pressure testing of hose to Australian Standard, applicable to that hose up to 2100kpa for 3 minutes
- Cleaning of fire hose including washing, rolling on light layflat hose and disposal of any contamination
- Test certification for:
 - Conformity
 - Pressure test
 - Binding integrity
- Services available for all other brands (subject to sighting and agreement) are:
 - Recoupling and banding of 38mm, 51mm, 64mm and 90mm hose
 - Patching, testing and drying of conventional hose only

Hose Services

Ordering information	Description
WW100	Wire Whip new hose
WW200	Test Certificate
WW400	Inspection maintenance full
WW500	Removal of hose couplings
WW600	Inspect and clean couplings
WW700	Repair extruded hose per hole
WW800	Full length PTest 3 mins @2100 kPa
WW850	Binding press, test coup hose

Fire Depot Bins

Ordering information	Description
Example.	Fire Depot Bin
	Removable Wire Basket
	Fire Hoses rolled and stored in bin
	Dividing breeches QRT or BI
	Branch Pipe Plastic QRT or BI
	Nozzles in brass or light alloy
	Hydrant spanner



Chubb offer a customised solution in depot bins. These are available in your choice of configuration.



Fittings & Couplings

Storz Fittings and Couplings

Designed to exceed the stringent demands of the fire fighting industry.

Certified products for effective and reliable hose connection for your water supply and distribution needs.

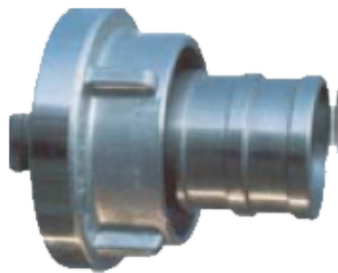

Ordering information	Description
Storz Hose Couplings - forged alloy hose couplings to DIN and NEN standards	
ST25COUPLT	25mm Storz X 19mm Hose Tail (ea)
ST25COUP25LT	25mm Storz X 25mm Hose Tail (ea)
ST38COUP	38mm Storz X 38mm Hose Tail (ea)
ST52COUP38	52mm Storz x 38mm Hose Tail
ST52COUP52	52mm Storz x 52mm Hose Tail
ST65COUP38	65mm Storz x 38mm Hose Tail
ST65COUP65	65mm Storz X 65mm Hose Tail (ea)
ST65COUP70	65mm Storz x 70mm Hose Tail (ea)
ST75COUP75	75mm Storz X 75mm Hose Tail (ea)
050-090	90mm Storz x 90mm Hose Tail (ea)
ST100COUP100	100mm Storz X 100mm Hose Tail (ea)
ST125COUP125	125mm Storz X 125mm Hose Tail (ea)
ST125CORRURH	125mm Storz x 125mm Hose Tail corrogrip hard anodised (each)
ST150COUP	150mm Storz X 150mm Hose Tail (ea)
Storz Adaptors - Male Thread - BSP	
ST2519MAD	25mm Storz X 3/4" BSP Male
ST2525MAD	25mm Storz X 1" BSP Male
ST3832MAD	38mm Storz X 1 1/4" BSP Male
ST3838MAD	38mm Storz X 1 1/2" BSP Male
ST6552MADA	65mm Storz x 2" BSP Male
ST6565SMAD	65mm Storz X 2 1/2" BSP Male (swivel)
ST7565MADA	75mm Storz X 2 1/2" BSP Male
ST7575MAD	75mm Storz X 3" BSP Male
ST100100MAD	100mm Storz X 4" BSP Male
ST100100MADL	100mm Storz X 4" BSP Male lockable
Storz Adaptors - Female Thread - BSP	
ST2519FAD	25mm Storz x 3/4" Female BSP
ST2525FAD	25mm Storz x 1" Female BSP
ST3832FAD	38mm Storz x 1 1/4" Female BSP
ST3838FAD	38mm Storz x 1 1/2" Female BSP
ST3852FAD	65mm Storz x 2" Female BSP
ST6551FAD	65mm Storz x 52mm BSP Female
ST6565FADA	65mm Storz x 64mm BSP Female
ST653FAD	65mm Storz x 75mm BSP Female
ST1255FADL	65mm Storz x 75mm BSP Female lockable
ST7565FADA	75mm Storz x 65mm BSP Female

Threaded couplings and Adaptors



Ordering information	Description
ST65CFAF	Storz 65mm x CFA 3TPI Female Swivel
ST65CFAM	Storz 65mm x CFA 3TPI Male
ST65NSWM	Storz 65mm x 2 1/2" NSWFB Male
ST65NSWF	Storz 65mm NSWFB standard 5 1/5 threads per inch
118902	Adaptor, 65mm Storz to 65mm QLD FM Round Thread

Storz Reducers



Ordering information	Description
ST38ST25SAD	25mm to 38mm Storz Reducer swivel
ST38ST6SAD	38mm to 64mm Storz Reducer swivel
ST75ST65SAD	Storz Reducer 75mm x 65mm Swivel
ST150ST125SAD	Storz Reducer 150mm x 125mm Swivel
ST100ST75SAD	Storz Reducer 190 x 75mm Storz Reducer swivel
ST125ST75AD	Storz Reducer 125 x 75mm Storz Reducer swivel
ST125ST100AD	Storz Reducer 125 x 100mm Storz Reducer swivel
ST150ST100SAD	Storz Reducer 150 x 100mm Storz Reducer swivel
ST150ST125AD	Storz Reducer 150 x 125mm Storz Reducer swivel
ST150ST125SAD	Storz Reducer 150 x 125mm Storz Reducer swivel

Storz Blanking Caps



Ordering information	Description
ST25BLCAP	25mm Storz Blanking cap with chain
ST38BLCAP	38mm Storz Blanking cap with chain
ST65BLCAP	65mm Storz Blanking cap with chain
ST75BLCAP	75mm Storz Blanking cap with chain
ST100BLCAP	100mm Storz Blanking cap with chain
ST125BLCAP	125mm Storz Blanking cap with chain
ST150BLCAP	150mm Storz Blanking cap with chain

Storz Washers - Suction & Delivery

Storz washers made from nitrile rubber



Ordering information	Description
ST25W	STORZ COMBO WASHER 25MM BLACK
ST38DW	STORZ DELIVERY WASHER 38MM BLACK
ST38W	WASHER COMBO STORZ 38MM BLACK
ST52DW	STORZ DELIVERY WASHER 52MM BLACK
ST52W	WASHER COMBO STORZ 52MM BLACK
ST65DW	WASHER DELIVERY STORZ 65 BLACK
ST65DWH	STORZ DELIVERY WASHER 65 HARD 24 BAR WORK/36 BAR BURST BLACK
ST65SDW	STORZ COMBO WASHER 65MM WHITE
ST65W	STORZ COMBO WASHER 65MM BLACK
ST65WHW	STORZ COMBO WASHER 65MM HARD 24 BAR WORK/36 BAR BURST BLACK
ST75DW	WASHER STORZ 75 DELIVERY BLACK
ST75SD	STORZ COMBO WASHER 75 BLACK
ST90W	STORZ COMBO WASHER 90MM BLACK
ST100W	STORZ COMBO WASHER 100MM BLACK
ST100WHW	STORZ COMBO WASHER 100MM HARD 24 BAR WORK/36 BAR BURST BLACK
ST125W	STORZ COMBO WASHER 125MM BLACK
ST152W	STORZ COMBO WASHER 152MM BLACK

Storz Suction Strainers



Ordering information	Description
ST38STRAINER	38mm Storz coupling, 40mm Diameter max
ST65STRAINER	65mm Storz coupling, 70mm Diameter max
ST75STRAINER	75mm Storz coupling, 85mm Diameter max
ST100STRAINER	100mm Storz coupling, 98mm Diameter max
ST100STRAINERLD	100mm Storz coupling, 156mm Diameter max

Storz Spanners



Ordering information	Description
005-038	Storz Spanner 38mm - 52mm
STASW-1	Storz Spanner Alloy 1/2 - 3"
STABCSP	Storz Spanner 75mm - 100mm Steel With Plastic Handle
150-191	Storz Spanner Folding / Adjustable



Forestry Couplings



Ordering information	Description
Forestry Couplings	
FORRHQK25T	Forestry External Lug Coupling Set 25mm ULC for textile hose
FORRHQK38T	Forestry External Lug Coupling Set 38mm ULC for textile hose
FORRHQK25	Forestry External Lug Coupling Set 25mm for extruded hose
FORRHQK38	Forestry External Lug Coupling Set 38mm for extruded hose
FORRHQK1F	Forestry External Lug x 25mm BSP Female
FORRHQK1FN	Forestry External Lug x 25mm NH Female
FORRHQK1M	Forestry External Lug x 25mm BSP Male
FORRHQK1MN	Forestry External Lug x 25mm NH Male
FORRHQK15M	Forestry External Lug x 38mm BSP Male
FORRHQK15F	Forestry External Lug x 38mm BSP Female
FORHQBLCAP	Forestry Blanking Cap
FA12	Forestry External Lug Coupling Face Washer

Forestry Expanders

Ordering information	Description
FORXPANDER	Brute X-Pander Forestry Coupler
FOR16152	25mm Expansion Mandrel
FOR16154	38mm Expansion Mandrel



Can't find what you're looking for?



Contact your Chubb representative to discuss your requirements.



British Instantaneous



Ordering information	Description
B.I. Couplings	
BIC2.538COUP	Coupling set x 38mm hose tail brass alloy
BIC2.538COUG	Coupling set x 38mm hose tail brass alloy
BIC2.545COUP	Coupling set 65 x 45 mm alloy
BIC2.545COUG	Coupling set 65 x 48mm brass
BIC2.552COUP	Coupling set BI 64 x 52 tail LA
BIC2.564COUP	Coupling set x 64mm hose tail - alloy
BIC2.564COUG	Coupling set x 64mm hose tail - brass
B.I. Adaptors - Male	
BIC2.5M38MADA	Male x 38mm BSP male - alloy
BIC2.5M38MBADA	Male x 38 BSP male - brass
BIC2.5M2MADA	Male x 65 x 52" BSP male - alloy
BIC2.5M2.5MADA	Male x 64mm BSP male - alloy
B.I. Adaptors - Male to Female	
BIC2.5F1.5FADA	Male x 50mm BSP female - brass
BIC2.5F2ADA	Male x 50mm BSP female - alloy
BIC2.5M2.5ADA	Male x 64mm BSP female - alloy
B.I. Adaptors - Female	
BIC2.5F1.5FADA	Female x 38mm BSP - alloy
BIC2.5F1.5FADA	Female x 65mm BSP - alloy
BIC2.5F2ADA	Female x 50mm BSP female - alloy
B.I. Blanking Cap	
BIC64MMCAP	Blanking cap - brass
BIPLUGA	BIC Male plug and chain
B.I. Washer	
KA3001	2.5" BIC coupling washer



Firefighting Foams

Firefighting foams can be broken into two broad categories:

- Foams which are fluorine free (F3)
- Foams which contain fluorinated surfactants.

However there are also individual foam types within these two broad categories.

Common Fluorine Free Foams

- F3—fluorine-free foam
- AR-F3 alcohol-resistant fluorine free foam

Note: Training, Hi-Expansion and Class A foams are, and always have been, fluorine free.

Fluorinated Foams

- AFFF aqueous film-forming foam
- AR-AFFF alcohol-resistant aqueous film-forming foam
- FP fluoroprotein foam
- FFFP film forming fluoroprotein foam
- AR-FFFP alcohol-resistant film-forming fluoroprotein foam

New generation fluorinated foams manufactured in accordance with the US EPA PFOA Stewardship program and are commonly referred to as C6 foams.

Importantly, C6 foams:

- Do not break down into chemicals currently listed or suspected of being Persistent Organic Pollutants.
- Are not listed by the Stockholm Convention or European Chemicals Agency current (2016) list of substances of high or very high concern (VHC).
- Do not contain or break down into PFOS.
- Although Persistent, C6 fluorosurfactants have low aquatic and human toxicity and been shown not to be Bioaccumulative.

Class A Foam



Forexpan

Forexpan is a synthetic firefighting foam specifically formulated for Class A applications such as forestry and wildland fire control, structural fires and paper fires.

The balanced chemical system in Forexpan reduce the surface tension of water to increase the penetration into burning Class A materials. Conforms to NFPA 1150.

Expandol

Class A Fires (wood, paper, timber etc.) are extinguished by wetting the combustible material, also preventing reignition. Foams that reduce the surface tension with water to increase penetrating power are best suited to Class A fires.

Expandol is a superior quality, high expansion fire fighting foam concentrate for extinguishing and securing flammable hydrocarbon liquid fires. Expandol produces large volumes of high expansion foam for use in total flooding applications, marine firefighting and LNG applications.

Expandol is intended for use at 1 - 3% (high expansion) to 3 - 6% (medium expansion).



Ordering information	Description	Key features
Forexpan		
FOREXS1000		1000L tote
FOREXPAN20NSW	NSW	Class A and small Class B 20 litre drum
FOREXS200		
Expandol		
EXPAN20	Foam Expandol high expansion, 20 ltr pail	
EXPAN200	Foam Expandol high expansion, 200 ltr drum	
EXPAN1000	Foam Expandol high expansion, 1000 ltr tote	
Training Foam		
TRAINBOT1	Trainol Training Foam - 6%	Super concentrate training foam 1 litre bottle

**In case of an
emergency you
should call:**

1800 099 255

Emergency Stock Program

Chubb Fire Products holds Emergency Stock quantities of fire fighting products including both Class A and Class B foams for use by its emergency services.

The service for provision of Emergency Stocks is available **24 hours a day, 365 days of the year.**

Class B C6 Foam



C6 Fluorosurfactants

These are highly effective agents available to tackle serious flammable liquid fires, providing firefighter safety and asset protection. Angus foams containing C6 surfactants utilise the very latest in firefighting foam technologies, developed and refined specifically to lower environmental impact without reducing performance.

Angus Foams use only pure C6 surfactants.

Tridol C6 S

Synthetic Aqueous Film-Forming Foam (AFFF) Concentrate

- Film-forming for fast flame knockdown and extinguishment
- Burnback resistance and post-fire security
- Environmentally balanced

TridolC6 S3 is a superior quality synthetic Aqueous Film-Forming Foam (AFFF) concentrate for extinguishing and securing flammable hydrocarbon liquid fires.

TridolC6 S3 is a unique combination of hydrocarbon and fluorochemical surface active agents. It produces a vapour-sealing aqueous film that spreads rapidly over the fuel surface to provide rapid control and extinguishment.

Tridol C6 ATF C

Alcohol Resistant Aqueous Film-Forming Foam (AR-AFFF) Concentrate

TridolC6 ATF C 3 is a competitive Alcohol Resistant Aqueous Film-Forming Foam (AR-AFFF) concentrate for extinguishing and securing flammable hydrocarbon and polar solvent liquid fires.

TridolC6 ATF C contains a combination of hydrocarbon and fluorocarbon surface active agents. It produces a vapour-sealing aqueous film that spreads over hydrocarbon fuels to provide rapid control and extinguishment. On polar solvents an insoluble polymer membrane is formed which protects the foam blanket from the destructive effects of the solvent.

- Versatile, eliminating the need to stock a variety of foam types.
- Film-forming on hydrocarbons for fast flame knockdown and extinguishment.
- Good burnback resistance and postfire security.
- Foam blanket re-seals when ruptured by personnel or equipment.

Ordering information	Description
TRIC6120	Foam Tridol C6 S 1%, 20l
TRIC61200	Foam Tridol C6 S 1%, 200l
TRIC611000	Foam Tridol C6 S 1%, 1,000l
TRIC6320	Foam Tridol C6 S 3%, 20l
TRIC63200	Foam Tridol C6 S 3%, 200l
TRIC631000	Foam Tridol C6 S 3%, 1,000l
TRIC6620	Foam Tridol C6 S 6%, 20l
TRIC66200	Foam Tridol C6 S 6%, 200l
TRIC661000	Foam Tridol C6 S 6%, 1,000l

Ordering information	Description
TRIAATFC6320	Foam Tridol C6 ATF C 3-3, 20l
TRIAATFC63200	Foam Tridol C6 ATF C 3-3, 200l
TRIAATFC631000	Foam Tridol C6 ATF C 3-3, 1,000l
TRIAATFC63620	Foam Tridol C6 ATF C 3-6, 20l
TRIAATFC636200	Foam Tridol C6 ATF C 3-6, 200l
TRIAATFC6361000	Foam Tridol C6 ATF C 3-6, 1,000l

Class B C6 Foam



Respondol Fluorine Free

Respondol foam concentrate has been designed as a multi-purpose fluorine free foam for those circumstances when minimising environmental impact is paramount.

- Respondol ATF 3-3% is Lastfire, UL and IMO certified
- Respondol ATF 3-3% and 3-6% are EN1568 Part 3 and 4 certified
- Fast knock-down and extinguishment exceeding the requirements of EN158 pt 3 & 4
- Lower viscosity than some fluorine free foams to ensure easy induction.
- Fluorine free to minimise environmental persistence

Respondol ATF is available in 3-3 or 3-6 and is a superior quality synthetic fluorine free (FF) foam concentrate, designed for extinguishing and securing all types of flammable liquid fires and Class A incidents. Respondol ATF has been designed specifically for general emergency responders who are faced with a variety of risks in a range of situations.

Ordering information	Description
RESATF3620	Respondol ATF 3-6 FF Foam, 20l drum
RESATF36200	Respondol ATF 3-6 FF Foam, 200l drum
RESATF361000	Respondol ATF 3-6 FF Foam, 1000 litre tote
RESATF33120	Respondol ATF 3-3 FF Foam, 20l drum
RESATF331200	Respondol ATF 3-3 FF Foam, 200l drum
RESATF331000	Respondol ATF 3-3 FF Foam, 1000 litre tote

Foam Testing Services

Foam testing is crucial in ensuring that stocks of foam concentrate held in long-term storage are in good condition when they are needed to put out a fire and are required to be conducted annually under AS1940-1993 Clause 9.8.15.

Chubb are able to offer foam testing services in a NATA accredited laboratory specialising in foam. Common tests include concentrate testing of AFFF and AR-AFFF foam and foam proportioning tests to ensure that foam equipment is proportioning at correct rates.

Chubb are also able to offer environmental testing of foam concentrate in accredited laboratories. These tests include TOPa and PFAS Extended Suite.

**Contact
Chubb
today.**

Foam Testing

Ordering information	Description
FOAMTEST	Foam test and reports
FOAMTESTAR	Foam test and reports - AR foam
FOAMTEST24	Foam test 24 hr turn around
FOAMTESTPS	Foam proportioning strength
FSKIT	Foam sample test kit, 4 x 1 litre bottle label and instruction kit

Protein Foam

Niagara C6 3-3

Alcohol Resistant Film-Forming FluoroProtein (AR-FFFP) Foam Concentrate

NiagaraC6 3-3 is a superior quality Alcohol Resistant Film-Forming FluoroProtein (AR-FFFP) fire fighting foam concentrate at 3% induction rate for extinguishing and securing both flammable hydrocarbon and polar solvent liquid fires.

- Virtually non-toxic to aquatic organisms. Based on a natural protein foaming agent and contains no harmful synthetic detergents, glycol ethers, alkyl phenol ethoxylates (APEs), tolyltriazoles, or complexing agents
- Easy pouring and induction
- Extremely low environmental impact
- Highly versatile
- Film-forming foam with fast knockdown
- Highly versatile - eliminates need to stock a variety of foam types
- Detergent-free for high resistance to fuel pick-up
- Foam blanket re-seals when disrupted by personnel or equipment

Ordering information	Description
NIGC6320	Niagara C6 3-3%, 20 litre
NIGC6320NSW	Niagara C6 3-3%, 20 litre - NSW ONLY
NIGC63200	Niagara C6 3-3%, 200 litre
NIGC631000	Niagara C6 3-3% 1000 litre tote

Tankmaster C6

FluoroProtein (FP) Fire Fighting Foam Concentrate

TankmasterC6 is a superior quality FluoroProtein (FP) fire fighting foam concentrate for extinguishing and securing flammable hydrocarbon liquid fires. TankmasterC6 is a powerful and cost-effective agent for the protection of a wide range of hydrocarbons including crude oil, regular leaded gasoline and unleaded gasoline.

- Lastfire, UL and EN1568 Part 3 approved
- Biodegradable and virtually non-toxic to aquatic organisms.
- Based on a natural protein foaming agent and contains no harmful synthetic detergent or glycol ether solvents.
- Highly fluid foam for rapid fire knockdown and extinguishment
- Extraordinary burnback resistance and post-fire security
- Detergent-free for high resistance to fuel pick-up
- C6 Fluorotelomers
- Stable long-lasting foam blanket for extraordinary burnback resistance and post-fire security.
- Excellent sealing action against hot metal surfaces.
- Foam blanket re-seals when ruptured by personnel or equipment.

Ordering information	Description
TANKC6320	20 litre
TANKC63200	200 litre
TANK631000	1000 litre



BlazeTamer™ 380



Ideally suited to aerial wildfire fighting



Water enhancers like the polymeric elastomer BLAZETAMER380™ represent the future for Aerial firefighting.

BLAZETAMER380™ is an effective and valuable fire suppressant for direct attack of fires during initial or extended attack operations. It can be used in fixed wing aircraft and Helicopters, utilising slingable bags, drop tanks, and can be ground-loaded, mixed in dip tanks for helicopters with buckets or used with on-board injection systems in helicopters, SEATs, water-scooping and land-based, multi-engine air-tankers. BlazeTamer380 is currently used in several states in Australia for aerial firefighting.



BLAZETAMER380™ is a non-coloured liquid concentrate water enhancer that is non-toxic, non-corrosive and environmentally safe. It is proven harmless to humans, animals and vegetation, complies with Work Health Safety Regulations for firefighters, and is approved for use by state and federal agencies. It is listed on the United States Forest Service Qualified Products List (QPL) and is environmentally safe enough to be aurally applied in Long Term Retardant Exclusion Zones if allowed by land management agency policy. It is safe to use around dams and waterways.

BLAZETAMER380 features include:

- Meets USDA Forest Service Requirement per specification 5100-306a
- Non-toxic, non-hazardous and non-corrosive
- Contains no alcohols, is biodegradable and requires no residual clean up
- Suitable for use with soft or hard, fresh, brackish or sea water
- Does not foam so is easily pre mixed
- Has excellent stability in pre mixed form
- Short lead time as it is Australian made

KEY BENEFITS

Advancements in technology have provided additives to enhance the effectiveness of water for fire suppression. In addition to foam and long-term retardants, water enhancers, including the polymeric elastomer BLAZETAMER380™, represent the future for direct aerial attack of wildland fires.

Drop Characteristics

When BLAZETAMER380™ is aurally delivered the effect of the linear chains of water causes drop characteristics that differ from water, retardant, foam or gels, since drop patterns are denser, provide more uniform coverage and have less drift, as proven in tests and studies conducted in the United States, Canada and Australia.

Less Evaporative Loss

Evaporative loss occurs when a product mix enters the airstream after leaving the aircraft and again as it moves through the thermal zone above a fire. The amount of loss varies with each product type, i.e., up to 35% of water and foam never reaches the intended target. The properties of BLAZETAMER380™ allow a significant increase of product reaching the intended target due to reduced evaporative loss and less drift.

Canopy Penetration

BLAZETAMER380™ penetrates a canopy better than retardant or gels. After a drop, long “strings” of water may be seen hanging from vegetation. These strings absorb thermal energy as they enter the thermal zone above a fire and their viscosity decreases after making initial contact with a canopy. Its ability to penetrate vegetation is similar to foam mixed at low concentrations. If fuels are torching or crowning, a mix ratio of 0.65% may reach and remain effective on ground fuels.

Endothermic Properties

BLAZETAMER380™ has unique fire suppression characteristics that, when applied to fire, rapidly reduces temperature to below the flash point of the fuels. This is most noticeable after it is applied since the reduction in heat causes less combustion and is visible through the reduction in smoke. .

Benefits Of Blazetamer380

BLAZETAMER380™ links all water molecules in a load together, are less prone to drift and it is not affected by water quality or salinity so mix ratios remain consistent, whatever the water source.

Air-tankers can effectively alternate loads of retardant and BLAZETAMER380™ without requiring the tank to be rinsed since the salt contained in any residual retardant does not affect the performance of BLAZETAMER380™.

** Do not mix with foam.

Ordering information	Description	Key features
BLAZE38020	BlazeTamer™ 380 Non Toxic Water Enhancer	<ul style="list-style-type: none"> Increases water efficiency for Class A fires Reduces re ignition Biodegradable, non-hazardous, non-corrosive (USDA-FS) with no alcohols 20 litres of BlazeTamer™ 380 will produce 10,000 litres of firefighting 20 litre, UL-approved, stackable containers
BLAZE3801000	Totes	1000 litre totes
FASTFILLER	Fast Filler mixer for BlazeTamer™	

FASTFILLER 15

The FastFiller is positioned between the water supply and the pump. When dosing the concentrate into a fixed volume of water this piece of equipment is virtually flawless in its design. Fill the hopper with the required concentrate and start the flow of water through the induction tube and open the ball valve, watch the concentrate as it's drawn down through the tube and into the water stream as it loads any type of aircraft or fire fighting engine. For large water tankers supplying ground based operations, this means delivering a product that's ready to be applied by the ground crews immediately. Ground base operations for LAT and VLAT delivering a product that is ready to be applied is a no-nonsense approach to an emergency situation.

Foam Equipment



Ordering information	Description	
Foam Equipment Uninductor		
AO2101001010	Uninductor 225 c/w Pickup Tube, 51mm BSP Male	
AO2201001010	Uninductor 450 c/w Pickup Tube 51mm BSP Male	
Foam Equipment Branchpipes		Key Features
AO51120	Angus Foamaster Non-Inducing 225 LPM 51mm BSP Male	
AO52120	Angus Foamaster Non-Inducing 450 LPM 51mm BSP Male	
SH225SHSPV3	Striker 225 LPM branchpipe c/w Storz Adaptor	
SH225SHSPV3-6	Striker 225 LPM branchpipe, 51mm BSP male self-inducing, 3-6%	
127-700	Foam Branch B65 Low Expansion c/w Forestry Lug	
106-DM25PM	DM25 Branch c/w 6mm Tip & Polyball, 25mm BSP F	
106-CMM38	38mm Triple purpose branchpipe, 38 mm Storz inlet	Jet spray water curtain and shut off 9mm detachable outlet nozzle
0500058 C4.2	9mm Detachable outlet tip	Use with triple purpose 2" branchpipes
0500058 C4.3	65mm Triple purpose branchpipe, 65mm Storz inlet	Jet spray water curtain and shut off 16mm detachable outlet nozzle
0500058 C4.4	16mm Detachable outlet tip	Use with triple purpose 2 1/2" branchpipes
S225SHMINES	Striker Mines Branchpipe Shoe	
S225SMINEFP15X	Striker Mines Branchpipe complete with FPV15X valve	
Foam Equipment - Portable Foam High Expansion Foam Generator		
A102071	Turbex Mark II Foam Generator High Expansion	
POLYDUC	Turbex Ducting 30m	
Foam Carts		
AF120225L	Angus AF120 c/w inductor 225 alloy	
AF120450L	Angus AF120 c/w inductor 450 alloy	

Forestry Equipment

Firebug Fire Control Torch

Fixed wand fire control torch
For forestry applications to intentionally ignite fires

Standard features include:

- A wick that will light the torch
- Consistent flow at a walking pace of 3-4 km per hour
- Designed for safety and reliability
- Lightweight aluminium construction for durability
- Controlled air inlet and liquid outlet for increased safety
- Simple and quick to operate

Ordering information	Description	Key features
FCT-1	4 litre drip torch	Runs on 25% petrol (gasoline) and 75% diesel
Firebug Spare Part Kits		
FCT-200	Kit and assembly less tap	Kit, bracket, bolt , nozzle, ignition wick
FCT-201	Kit bleed screw	Kit, bleed screw, O ring, washer, housing and tube, retainer
FCT-202	Kit O rings and washer	Kit, O ring bleed screw, O ring filler cap, nylon washer - quantity 6 of each
101055	Kit spare cap	Spare cap complete
FCT-101	Bracket Wick and bolt	Bracket Wick to suit 7 pint
FCT-106	Ignition Wick	Ignition Firebug to suit 7 pint
FCT-102	Nozzle	Nozzle
FCT-107	Wand extension less nozzle	Wand extension
FCT-108	Fuel control tap	Fuel control tap

Rega Knapsack



The Rega knapsack is manufactured from tough UV stabilised polythene. It holds 16L of water with a typical application of >2LPM with a spray distance of >3m and jet distance of >5m

The Rega Knapsack:

- Meets requirements of AS1687
- Tough, light weight, high density UV stabilised polythene water container
- Large filler opening
- Built-in strainer at water container outlet
- “Snap in” fitting on water tank for hose and hand pump
- Swivel hose outlet
- Adjustable shoulder straps with padding
- Brass double action underarm pump
- Adjustable nozzle allows a straight jet or variable fan spray
- Optional vehicle bracket

Ordering information	Description
Rega Spares	
109792	Lid assembly
109787	Plunger assembly
109769	Hose assembly
109727	Pump assembly
109778	Service kit

Forcible Entry Tools

Hooligan heavy duty forcible entry tools are designed to break through most barriers encountered in a rescue situation.

Standard features include:

- Ends forged in high alloy aircraft steel
- Fine tapered ends to facilitate entry
- Chrome plated finish
- Available in various lengths

Ordering information	Description
119691	Hooligan Tool 760mm
119692	Hooligan Tool 914mm
SQB420C	Hooligan Tool 1066mm

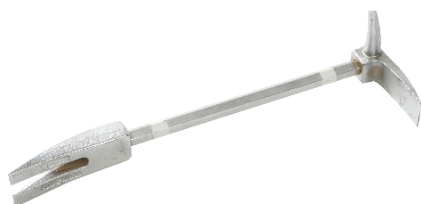

MFC Survival

High Pressure Airbags



Ordering information	Description
HB0004	Taskforce Kevlar Powermats, Type KS11
HB0005	Taskforce Kevlar Powermats, Type KL12
HB0006	Taskforce Kevlar Powermats, Type KS20
HB0007	Taskforce Kevlar Powermats, Type KL24
HB0010	Taskforce Kevlar Powermats, Type KS29
HB0011	Taskforce Kevlar Powermats, Type KL40
HB0014	Stak-Jak, Type KSM11 complete with clips
HB0015	Stak-Jak, Type KSM15 complete with clips
SP0100	Valise

Controllers and Regulators



Ordering information	Description
HH020	Hand Held Controller - Twin
CO0022	Combined Controller/Regulator 8.0 bar (twin) Type 530/646
RE0015	New Cylinder/Regulator Type 646 30psi c/w hose and box
RE0016	New Standard Cylinder/Regulator Type 855 125psi (8bar)
SP0007	Delivery hose 10m with safety lock couplings - red
SP0008	Delivery hose 10m with safety lock couplings - green

Low Pressure Airbags

Ordering information	Description
LB0035	Type A Lifting Cushion
LB0036	Type B Lifting Cushion
LB0037	Type C Lifting Cushion
LB0038	Type D Lifting Cushion
LB0039	Type AK Lifting Cushion
LB0040	Type BK Lifting Cushion
LB0041	Type CK Lifting Cushion
LB0042	Type DK Lifting Cushion
LB9001	Carry Valise (for 2 cushions)

Rapid Response Shelters

Ordering information	Description
SH0001	Shelter - Type 9 (3 x 3 x 2.4)
SH0002	Shelter - Type 12 (4 x 3 x 2.4)
SH0004	Shelter - Type 20 (5 x 4 x 3)
SH0044	Shelter - Type 9 with removable floor
SH0045	Shelter - Type 16 with removable floor
SH0046	Shelter - Type 36 with removable floor
SH0047	Shelter - Type 12 with removable floor
SH0048	Shelter - Type 25 with removable floor

Decontamination Showers

Ordering information	Description
DS0017	Single Person Decontamination Shower - 2.0m x 2.2m x 2.5m
DS0018	Four Person Decontamination Shower - 4.85m x 3.1m x 2.6m
DS0019	Mass Decontamination Shower - 7.5m x 4.7m x 2.9m

Water Rescue Equipment



Ordering information	Description
WR0001	RS3 Rescue Sled c/w paddles
WR0002	RS5 Rescue Sled c/w paddles
WR0003	RS10 Rescue Sled c/w paddles
WR0004	RS10T motorised sled w/o motor, c/w paddles
WR0006	RS15T motorised sled w/o motor, c/w paddles
WR0007	RP3 Rescue Platform
WR0011	2m Airtrack c/w delivery hose
WR0014	5m Airtrack c/w delivery hose
WR0015	10m Airtrack c/w delivery hose
WR0019	5m Airtrack with Kevlar c/w delivery hose
WR0020	10m Airtrack with Kevlar c/w delivery hose
WR0021	Hand Held Hose Inflation Kit
WR0043	Rescue Stick
WR0088	275n Stormbreaker Lifejacket Auto, light, twin crotch strap
WR0089	175n Stormbreaker Lifejacket Auto, light, twin crotch strap
WR0090	PFD
WR0126	Fibreight Cradle 6

Water Rescue Equipment cont..



WR0137	Fibreight Cradle 4
WR0139	Fibreight Cradle 2
WR0140	Fibreight Cradle 5
WR0143	Mud Lance Mk2
WR0144	Hose inflation End Capa c/w valves in storage bag
WR0149	RS10T c/w paddles, lifting and paddles patches and ID plate
WR0150	125mm neoprene animal rescue path, 5m long
WR0151	API Stretcher with removable cover
WR0169	RS6 Rescue Sled with paddle and storage valise

Water Storage



Ordering information	Description
TANK7500	Collapsible tank 7500ltr
Cover7500	Tank Cover
Float7500	Tank Float
Valise	Ground Sheet
WS0016	Pillow Water Storage Tank - 500 litres
WS0017	Pillow Water Storage Tank - 1000 litres
WS0024	Pillow Water Storage Tank - 10,000 litres
WS0039	2,500 litre Water Storage Reservoir Stella Meta
WS0044	Emergency Water Storage Reservoir - MFC stuck black (1333gal - 6000ltr)
WS0045	Emergency Water Storage Reservoir - MFC stuck black (1778gal - 8000ltr)
WS0056	10,000 litre Reservoir c/w 4" coupling and ball valve



Hazmat Equipment

Ordering information	Description
HAZSP60L	60L Hazspill drums to suit 20L drums
HAZSP360L	360L Hazspill drums to suit 200L drums
SBMSH3180	3m Oil Absorbent Booms
PCBSF1.2	Side entry pit blocker 1.2m
PCBSF2.4	Side entry pit blocker 1.2m
PROS20	20kg Prosorb





RESPIREX

GTL Lightweight Suit

A lightweight, fully encapsulating, Type 1A - ET gas-tight suit, designed to protect the emergency responder against toxic, corrosive gases, liquids and solid chemicals.



- Ten year shelf life (seven years maintenance free)
- Compatible with the Permeasure® Toxicity Modeller for calculation of safe working time with a given chemical based on real world conditions
- Fully encapsulating design to allow breathing apparatus to be worn inside the suit
- Manufactured in yellow Chemprotex™ 400 a light weight high performance chemical barrier, multi-layer non-woven fabric
- Heavy-duty 122cm (48") long gas-tight zip, fitted to the right hand side of the suit; a flap with a hook and loop fastener fitted to cover the teeth of the zip
- Adjustable internal support belt and bat-wing sleeves for optimum wearer comfort
- Flexible, multi-laminated, anti-mist visor giving clear undistorted vision
- Chemically protective, laminated glove welded to the suit material with an elasticated over-sleeve to prevent splash entering the supplied Neoprene outer gloves
- Integral socks with outer splash guards
- Pressure test & inspection required at year seven

Limited Life Suits

Tychem® TK Suit

Fully encapsulating Type 1A - ET limited life gas-tight suit manufactured in DuPont™ Tychem® TK a high performance, seven layer, non-woven, chemical barrier fabric.

- Maintenance free for the first five years unless used (see below)
- Ten year shelf-life
- Fully encapsulating design to allow breathing apparatus to be worn inside the suit
- Heavy duty 122cm (48") long gas-tight zip, fitted to the right hand side of the suit - flap with a hook and loop fastener fitted to cover the teeth of the zip
- Adjustable internal support belt and bat-wing sleeves for optimal wearer comfort
- Flexible, multi-laminated, anti-mist visor giving clear undistorted vision
- Detachable gloves fitted using gas-tight locking cuff mechanism
- Bonded inner & outer gloves provide chemical and mechanical protection
- Supplied with detachable Hazmax™ FPA safety boots for speed of donning and increased user comfort, sock feet with outer splash guards available as an option
- Pressure test required annually from year five or after each use

Options:

- Air-line pass-through for supplementary air
- Equipment attachment points

Disposable Splash Suits



Ordering information	Description
SC4	SC4 Splash Suit Limited Life Chemprotex 300
LLCS002/S	Chemprotex 300 Disposable Splash Suit Coverall with Integral sock, small
LLCS002/M	Chemprotex 300 Disposable Splash Suit Coverall with Integral sock, medium
LLCS002/L	Chemprotex 300 Disposable Splash Suit Coverall with Integral sock, large
LLCS002/XL	Chemprotex 300 Disposable Splash Suit Coverall with Integral sock, X-large
LLCS002/XXL	Chemprotex 300 Disposable Splash Suit Coverall with Integral sock, XX-large
COMB233/132S	Chemprotex 300 Lightweight Combi Splash Disposable - Small
COMB233/132M	Chemprotex 300 Lightweight Combi Splash Disposable - Medium
COMB233/132L	Chemprotex 300 Lightweight Combi Splash Disposable - Large
COMB233/132XL	Chemprotex 300 Lightweight Combi Splash Disposable - X Large
COMB233/132XXL	Chemprotex 300 Lightweight Combi Splash Disposable - XX Large
SC1042/132S	SC1 Splash Suit Blue Laminate - Small
SC1042/132M	SC1 Splash Suit Blue Laminate - Medium
SC1042/132L	SC1 Splash Suit Blue Laminate - Large
SC1042/132XL	SC1 Splash Suit Blue Laminate - X-Large
SC1042/132XXL	SC1 Splash Suit Blue Laminate - XX-Large
SC1004/17S	SC1 Splash Suit Neoprene - Small
SC1004/17M	SC1 Splash Suit Neoprene - Medium
SC1004/17L	SC1 Splash Suit Neoprene - Large
SC1004/17XL	SC1 Splash Suit Neoprene - X-Large
SC1004/17XXL	SC1 Splash Suit Neoprene - XX-Large

Air Fed Suits

Type 2 'non gas tight' suit designed for use with breathable air supplied from an external compressed air source providing positive pressure.

Ordering information	Description
SIMT 105/17S	Simplair Tank Suit Neoprene Small
SIMT 105/17M	Simplair Tank Suit Neoprene Medium
SIMT 105/17L	Simplair Tank Suit Neoprene Large
SIMT 105/17XL	Simplair Tank Suit Neoprene X-Large
SIMT 105/17XXL	Simplair Tank Suit Neoprene XX-Large



Kool Vest



Ordering information	Description
KLV/0001/A1	Koolvest in Proban Flame Retardant Material with Thinsulate Insulation, one size fits all
G00651	Koolpack (Single)

Body Bags



Ordering information	Description
TBB003/S	Infant/Fragment Size Body Bag
TBB003/M	Medium Adult Size Body Bag
TBB003/L	Large Adult Size Body Bag

Gloves and Boots



Ordering information	Description
Respirex Boots and Overboots	
B00847 - B00857	Hazmax Boots - UK Sizes 3-15
B01160 - B01162	Hazmax Maxi Overboots - Sizes M/L/XL
B01176 - B01178	Hazmax Compact Overboots - Sizes M/L/XL
B01287 - B01299	Hazmax ESD Boots - UK Sizes 3-15
B01152 - B01154	Hazmax ESD Maxi Overboots - Sizes M/L/XL
B00950 - B00960	Dielectric Boots - UK Sizes 3-15
B01170 - B01172	Dielectric Maxi Overboots - Sizes M/L/XL
B01180 - B01182	Dielectric Compact Overboots - Sizes M/L/XL
B01723 - B01735	Dielectric Hv3 Moulded Sole - UK Sizes 3-15
B01703 - B01715	Dielectric Hv3 Rubber Sole - UK Sizes 3-15
B01736 - B01738	Dielectric Hv3 Maxi Overboots - Sizes M/L/XL
Respirex Gloves	
G01565	Double Gloves System (Neoprene/Kemblok)
G00386	Kemblok Gloves
B00180 - B00183	Neoprene Splash Suit Gloves - Sizes 8-10
B00210 - B00212	Neoprene Gas Suit Gloves - Sizes 8-10

Thermal Imaging Cameras

The World's **Sixth Sense**®

Ordering information	Description
FLIRTICK33	K33: One-button, handheld thermal imaging camera, 240x180 pixels including FSX
FLIRTICK45	K45: Handheld thermal imaging camera, 240x180 pixels including FSX
FLIRTICK53	K53: Handheld thermal imaging camera, 320x240 pixels including FSX and onboard video recording
FLIRTICK55	K55: Handheld thermal imaging camera, 320x240 pixels including FSX and onboard video recording
FLIRTICK65	K65: Handheld thermal imaging camera, 320x240 pixels including FSX and onboard video recording

Note: This product is explosion proof, certified according to ANSI/ISA 12.12.01 (Class I, Div 2, Gas Groups C & D)

Flir K-Series Optional Accessories

Ordering information	Description
T198310ACC	Li-ion Battery Pack, 3.6V 16Wh
T198125	Battery charger, including power supply with multi plugs
T198322	In-truck charger
T198441ACC	Transport case
T127724ACC	Neck strap
T127722ACC	Retractable lanyard
T198416ACC	Strap lanyard
T198457ACC	Tripod Adapter
1910423	USB cable St A <-> Mini-B
T910814	Power Supply including multi plugs
T198509	Cigarette lighter adapter kit, 12 VDC, 1.2m
T911309ACC	Screwdriver TX20 (for use in K65)
T199398	Accessory Kit including neck strap, retractable lanyard and lanyard strap (for use in K65)

Flir K2

Ordering information	Description
FLIRTICK2	K2 Handheld thermal imaging camera, 160 x 120 pixels including MSX <i>K2 Box contents include thermal imaging camera, battery x 2, lanyard strap, power supply, printed documentation, USB cable, user documentation CD-ROM</i>
K2 Optional accessories	
T199414	Truck Charger
T199127	Li-ion Battery Pack, 3.6V 2.6 Ah for Kx
T199128	Battery charger Kx, including power supply with multi plugs
T198533	USB cable St A <-> Micro-B
T198532	Car charger (12V to USB micro B on 1.2m)
T199130	Strap lanyard Kx
T199357	Hard Case K2
T127722ACC	Retractable lanyard



Visit the Chubb website at
www.chubbfiresecurity.com

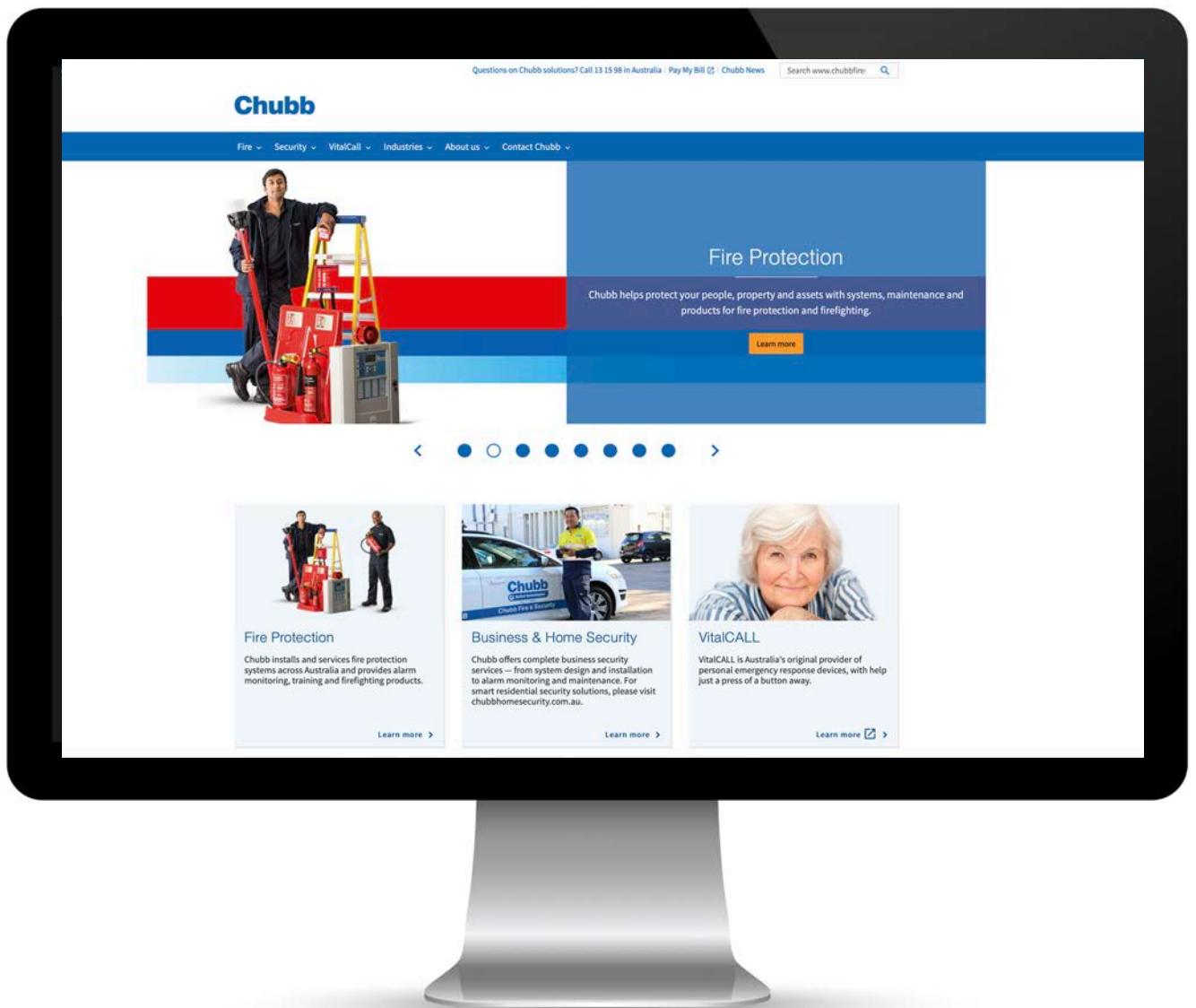

Chubb Fire & Security

314 Boundary Road
Dingley, Victoria 3172

Phone: 1300 550 574
Email: csproducts@chubb.com.au

Visit our website at www.chubbfiresecurity.com

